



MAHARERA
P53100030929

शमानंद रेसिडेन्सी

निसर्गरम्य
परिसर,
आपल्या स्वप्नांना
अधिकच सुखद
बनवेल.



Member of
CREDAI
SANGLI

बुकिंगसाठी संपर्क :
मो. 8668653433
मो. 7020095229
मो. 8087160111



विश्वासाच्या माणसांकडून
दर्जेदार बांधकाम



Typical Floor Plan (1st, 2nd, 3rd, 4th, 5th, 6th)

Flat No.	Type	Carpet	Built Up	Common	Consideration
301,401,501,601	2 BHK	709	800	80	880 Sq.ft
302,402,502,602	2 BHK	709	800	80	880 Sq.ft
203,303,403,503,603	1 BHK	477	550	80	630 Sq.ft
204,304,404,504,604	1 BHK	477	550	80	630 Sq.ft

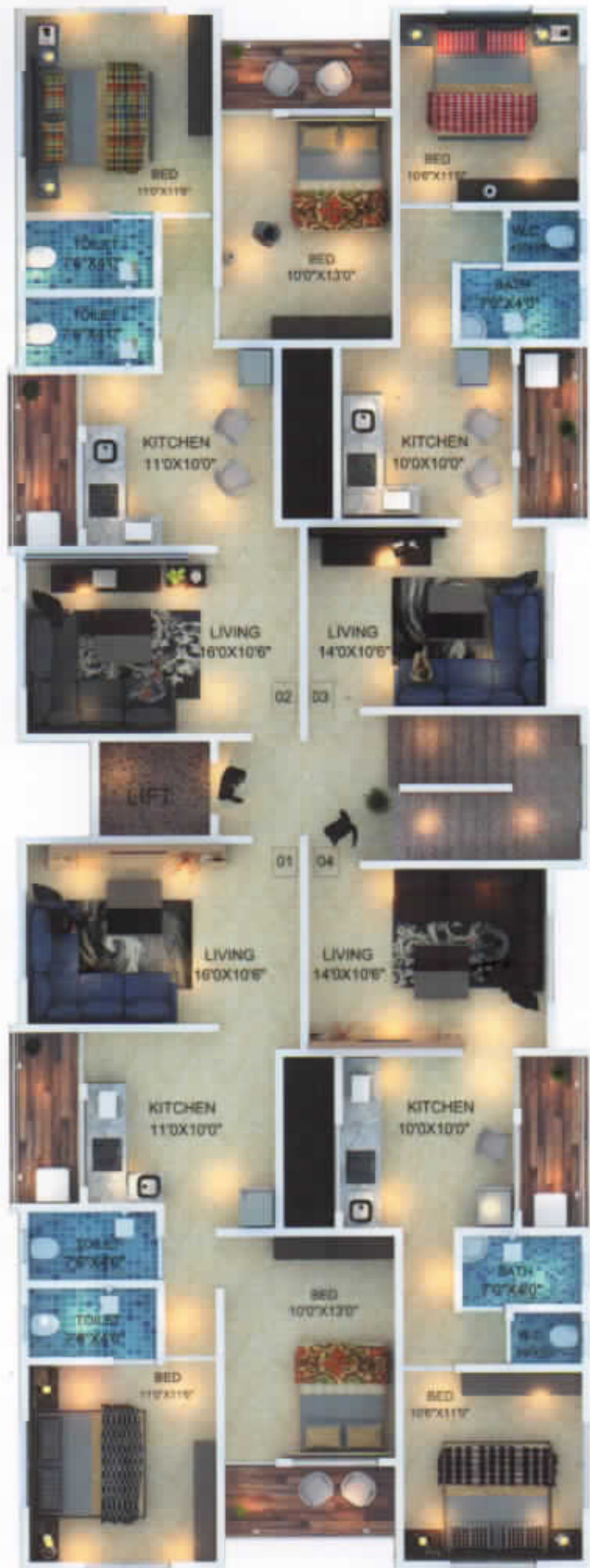

Road



RERA Approved
Clear Title Project

रामानंद

रेसिडेन्सी

Specifications



Quality Construction
with all checks
under Experienced
Supervision



Well Ventilated
Spacious Flats



Ample Water of
Corporation &
Bore



Best location with
good locality



100 meter from
Vishrambag
Railway Station



Datta, Hanuman
Mandir only 500
meter away



Adjacent to Kid's
Play Park



Home Loan
Approved by HDFC
& all Leading Banks



Walls in Red
Bricks



CCTV covering
parking &
Entrance



4 Person Lift



Battery Backup
for Lift



CERA / Jaguar CP
Fittings



An open stage on
Terrace for small
Functions



Our 17th
Successful
Project in Row



Experience of 25
years in Core
Engineering in Quality,
Planning & Execution



Reputation of on
Time Project
Delivery



Our 4.8 Star
Review Status
on Google



Quality
Construction by
Trustworthy People





आमचा अन्ध गृह प्रकल्प

रेसिडेन्सी
सुखकृती

सर्वातन सुखसुविधांनी युक्त
लक्झरी अस घरे

साईट पत्ता : विद्याता कॉलनी, गव्हर्नमेंट कॉलनी,
वृंदावन व्हिलाज समोर, विश्रामबाग, सांगली

रामानंद
रेसिडेन्सी

निसर्गरम्य परिसर, आपल्या स्वप्नांना
अधिकच सुखद बनवेल.

reflection 8175893171

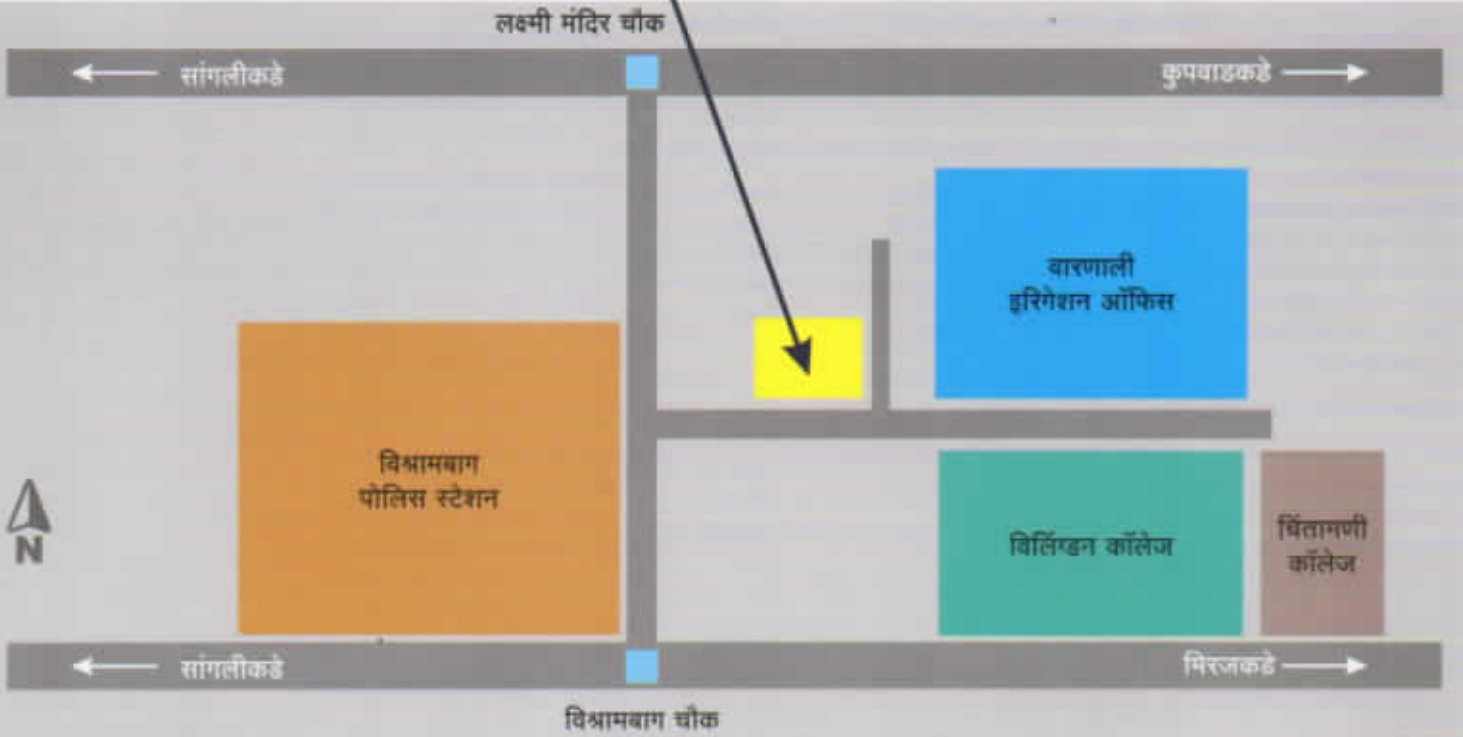

साईट पत्ता : वारणाली, विद्यानगर, गल्ली नं. १, विश्रामबाग, सांगली ४१६ ४१५.



Phadke Developers

Kaleshwar Niwas, Near Khare Sanskrutik
Bhavan, Vishrambag, Sangli, 416415.

Contact No : 8668653433, 9225890777

Email : pradeep_phadke@yahoo.co.in

Web : www.phadke-developers.com